

# Moorings 5000 Crewed

## Specifications and Equipment List - Moorings Upgrades In Bold

### DECK & HULL

---

- Forward lounging cockpit with hardtop with watertight saloon access door and sliding hatch for easy foredeck access
- Fold down forward cockpit table
- Hardtop over fwd and aft cockpit complete with LED down lighting and concealed rope lighting in fwd and aft cockpit
- Hardtop bimini over helm with supports and LED lighting
- **Helmsan enclosure - includes shade cloth sides and back**
- Upholstered helmseat with cushion and upholstered backrest
- Compass at helm position
- Rope bag at helm with integral winch handle pocket
- Hardtop supports
- Cockpit table
- **Stainless steel cockpit table stools**
- 3 x Drinks holders - 2 in fwd cockpit and 1 at helm
- **Aft cockpit side back shade curtains**
- Sliding companionway door/window
- Guardwires with stanchions, bases, port & starboard side gates
- Guardwires across bow and stern
- 1600w verticle windlass with 10mm gypsey with handheld remote
- Anchor bow roller fitting
- Anchor chain stopper
- 1 x Anchor/windlass locker with chain bin
- 3 x Foredeck/forward cockpit lockers
- Lifteraft locker with convertible fore/aft seat bolster in aft cockpit
- Acrylic smoke grey tinted windows
- **Coach roof side window removable shade covers**
- 5 x Size 10 flush hatch over heads
- 5 x Size 44 flush hatch over cabins
- 1 x Size 60 flush hatch over port forepeak (includes mushroom cowl)
- 2 x Size 5 portlights in windscreen
- 8 x Size 1 portlights in hull side
- 2 x Custom portlights in transom
- 2 x Pulpits with seats
- 2 x Pushpits
- 2 x Coachroof handrails
- 2 x Hardtop grab handrails
- 2 x Transom grab rails
- 9 x 260mm mooring cleats
- Trampoline
- Folding swim ladder with teak steps
- Gas cylinder regulator in dedicated cockpit LPG locker
- Moorings striping and graphics
- Emergency ladder on port transom
- **Electric grill built into wet locker in aft cockpit**
- **Winch type lifting platform with folding chocks**
- **Stainless steel dive bottle rack on swim platform - Holds 4 bottles total**
- **Composite teak decking: aft & fwd cockpits, helm platform, transom steps, side deck steps, flybridge and lifting platform**

### FLYBRIDGE

---

- **Lounging flybridge area with seating, sunbed, table and shade awning**
- **2 x External speakers on flybridge with wired remote and amplifier**

### SALOON/INTERIOR

---

- Laminate finish with solid wood trims
- Wear resistant simulated wood flooring
- U-shaped settee
- **Saloon table convertible to a coffee table in addition to standard double bunk conversion**
- Faux leather saloon cushions
- Overhead skylight
- Concealed overhead rope lighting
- Ventilation through forward facing portlights and watertight door

- **Interior saloon blinds - front & side windows**
- Stowage space under settee cushions
- 2 x Upholstered ottoman stools to be used as chart table seat or settee seating
- Forward doorway access to forward cockpit and foredeck
- Access to aft cockpit through sliding door/window
- Joinery staircase to hull accommodation
- **Safe with digital combination lock located in the saloon**

## GALLEY

---

- High quality galley worktop surfaces
- Single lever mixer faucet with pull-out sprayer
- Large bowl stainless steel sink
- Dish and cutlery drying recess with drainage and cover
- 4-burner Gas stove and oven
- Gas detectors in each hull connected to alarm in saloon
- Gas solenoid shut-off valve with control at switch panel & warning light at cooker
- Vitrifrigo 2-drawer fridge/freezer 56USgal / 212L 12v
- Separate garbage bin locker
- Stowage space in shelf lockers
- Stowage space under floorboards
- Pot drawer under oven
- 3 x Drawers alongside oven
- Outboard galley shelf with microwave
- **Additional 12v fridge installed in galley**

## NAVIGATION CONSOLE

---

- Chart table with stowage locker under hinged lid
- Stainless steel backrest railing
- Storage locker under chart table
- LED overhead lighting

## STANDARD CABINS x 3

---

- Laminate finish with solid wood trims
- Wear resistant laminate flooring
- Forward Port Bunk (59in / 1.50m x 80in / 2.03m)
- Forward Starboard Bunk (68in / 1.72m x 80in / 2.03m)
- Aft Port Bunk (68in / 1.72m x 80in / 2.03m)
- Bedside tables (starboard forward and port aft cabin only)
- Bedside cave locker inboard (port forward & aft cabins only)
- Stowage drawer under each bunk
- Stowage space under floorboards
- Concealed overhead rope lighting
- Concealed under bunk rope lighting
- 2 x LED reading lamps in each cabin
- Large hull window incorporating portlight and pleated blind
- Transom portlight in aft cabin with pleated blind
- Large open shelves
- Hanging locker
- LED overhead lighting

## MID CABIN

---

- Laminate finish with solid wood trims
- Wear resistant laminate flooring
- Double berth (68in / 1.72m x 80in / 2.03m)
- Bedside table forward
- 1 x Hanging locker
- 1 x Stowage drawers under bunk
- LED overhead lighting
- Concealed overhead rope lighting
- Concealed under bunk rope lighting
- 2 x LED reading lamps
- Overhead roller blinds for privacy
- Hull window incorporating portlight and pleated blind

## STARBOARD AFT CABIN

---

- Laminate finish with solid wood trims
- Wear resistant laminate flooring
- Double berth (68in / 1.72m x 80in / 2.03m)
- 1 x Hanging locker
- Bedside table outboard
- Bedside cave locker inboard
- 1 x Stowage drawers under bunk
- LED overhead lighting
- Concealed overhead rope lighting
- Concealed under bunk rope lighting
- 2 x LED reading lamps
- Overhead roller blinds for privacy
- Large hull window incorporating portlight and pleated blind
- Transom portlight in aft cabin with pleated blind

## PORT FOREPEAK

---

- **Port forepeak berth and head incl. light, fan, large bowl electric toilet, holding tank, shower sump with electric pump, hand basin c/w combination faucet/shower mixer and outlet socket with USBs and A/C**

## HEAD COMPARTMENTS x 5

---

- **Electric fresh water flushing toilets**
- Shower compartment with lever mixer and adjustable shower hose
- Shower sump with automatic drainage system
- Washbasin with basin mixer and Corian® worktop
- Under-basin locker with toilet roll holder
- Dedicated trash can locker
- Vanity locker with mirror
- Sliding head door with coat hook
- Double towel rail, ring and coat hook
- Overhead roller blinds for privacy in combination with roller bug screens
- Portlight with roller blind
- LED overhead lighting
- Sliding or hinged heads door

## MAST, RIGGING & SAILS

---

- **Custom heavy duty battened charter mainsail**
- **Upgraded heavy duty furling genoa with UV protection**
- **Stackpack LazyJack system in Moorings blue with logo**
- Bridle mainsheet system (3:1 purchase) comprised of 2 mainsheets
- 2 x Winch handles
- 2 x Mainsheets (3:1 purchase)
- 2 x Genoa sheets
- 3 x Halyards (main, genoa & spare)
- 2 x Single line reefs lead aft
- Main boom topping lift
- Natural anodized mast and boom
- Natural anodized crossbeam with mooring cleats
- Wind indicator
- **ProFurl furling system**
- 2 x Additional spare 12v wires in mast
- Additional spare conduit with messenger in mast
- 2 x Primary electric winches
- **1 x Electric mainsheet winch**
- 2 x Genoa cars
- 2 x Genoa tracks
- 1 x Halyard clutch at helm (mainsail)
- 1 x Halyard clutch at helm (gennaker)
- 2 x Genoa clutch at helm
- 2 x Mainsheet clutch at helm
- 2 x Reef clutch at helm
- 1 x Clutch and cleat on mast for genoa halyard
- 1 x Furler catch

## ENGINE & CONTROLS

---

- 2 x Yanmar 57hp diesel engines with sail drives
- 2 x Fuel tanks 243USgal / 920ltr total capacity

- 2 x Fuel deck fillers
- 2 x Fuel filters / digital water sensors
- Double lever throttle / gearshift control
- Sound deadening panels in engine room
- 2 x Engine room ventilation fans and ducting
- 2 x Exhaust skin fittings (stainless steel)
- 2 x Exhaust water locks/mufflers
- 2 x Cooling water inlet strainers
- 2 x Exhaust cooling water temperature sensors with audible alarms at helm
- 2 x Fixed blade propellers
- **Sterling alternator to battery charger**

## ELECTRICAL INSTALLATION

---

- **8kW Global shore power includes 125/250V 50A shore power cable with stainless steel inlet, US 125/250V 50A to Euro 230V 32A adapter, reverse Y adapter, 125/250V 50A inlet, 8kW isolation transformer with boost function and AC switch panel.**
- 1 x 12v Outlet socket at helmstation
- 2 x Fuel tank gauges at helm position
- 2 x Ammeters at helm position
- **House battery bank -- 5 AGM batteries totalling 1050ah**
- **2 x AGM Engine start batteries**
- 2 x Engine starter battery isolator switches
- 1 x House battery isolator switch
- 1 x Electrical spares kit: fuses, relays, fuse holders
- 2 x Alternators, standard with engines
- **12V 100A Battery charger**
- **3000w 110/60Hz Inverter**
- **Link engine starter batteries to house batteries. Operated from push button at helm.**
- 2 x USB outlets at chart table
- 2 x USB outlets at fridge locker
- 2 x USB outlets at saloon settee
- 2 x USB outlets in each cabin
- **Raymarine Instrument Package: Includes color autopilot display, 9" Multifunction display, Colour instrument and Remote buttons at Helmstation. With depth & wind transducer**
- **VHF at Navstation & additional VHF handset at helm**
- **Fusion Marine Stereo with docking station in saloon. Includes Bluetooth, USB & AUX connectivity**
- **2 x Speakers in saloon and aft cockpit**
- **Wired stereo remote control at helm station**
- **2 x External speakers in forward cockpit with wired remote and amplifier**
- **9kW (110v) / 7kW (220v) Generator supplied from aft port fuel tank, fuel transfer ability from stb to port tank**
- **Chilled water air conditioning system with 6 x digital control panels.**
- **TV/DVD and bracket in the saloon**
- **Moorings marine smarhub (wifi via cellular network and stored local content)**
- **LED lights throughout**
- **Blue Underwater Lights**
- Bi-color & stern navlights
- **Raymarine aft facing Camera**
- **Raymarine forward facing camera**
- **12V Refrigerator in cockpit**
- Concealed overhead rope lighting
- **2 x Solar panels 100w each**
- Digital monitoring
- **Raymarine Automatic identification System with AIS 650 Transceiver**

## RUDDER & STEERING SYSTEM

---

- High performance spade rudders
- Rudder stock in F16ph stainless steel
- Self aligning bearings
- Chain and wire steering system with bulkhead steering unit and brake
- Destroyer-type steering wheel
- Stainless steel emergency tiller

## PLUMBING INSTALLATION

---

- 2 x Water tanks, 185USgal / 700ltr total capacity
- **Watermaker: Sea Recovery (220V) 117 ltr/31 US gal per hour**

- Hot and cold pressurized fresh water system
- **Transom shower with hot and cold water mixer**
- 4 x Automatic shower drain pumps
- 1 x Fresh water pressure pump with accumulator tank
- 2 x Hot water tanks with total capacity 12USgal / 46L
- Holding tanks, 44USgal / 165ltr total capacity
- 2 x Electric bilge pumps (keel sump) with float switches and alarm at switch panel
- 2 x Manual bilge pumps
- 2 x High water bilge float switches with alarm at switch panel
- 2 x Electric bilge pumps (engine room) with alert at switch panel

## SAFETY GEAR

---

- **6 x Mooring / dock lines**
- **6 x Fenders**
- **35lb Britany anchor with chain & warp**
- **55lb Stainless steel anchor with 230Ft / 70m galvanized chain**
- **Anchor bridle, shackles and hook**
- **Life jackets and safety harnesses per max pax**
- **Bell**
- **Flare kit**
- **Binoculars**
- **Navigation tools: Parallel rule, compass, dividers**

## GENERAL EQUIPMENT

---

- Owner's Operating Manual
- 6 x Fire extinguishers
- Automatic extinguishing system for engine rooms
- NMMA Certification
- CE Certification

## CRUISING GEAR

---

- **Fitted cushions forward and aft cockpit**
- **Bed linens per max pax**
- **Plates, cups, saucers, glasses per max pax**
- **Flatware per max pax**
- **Pots, pans, miscellaneous food prep tools**
- **Cooking and serving utensils**
- **Coffee pot, tea kettle, toaster**
- **Towels and washcloths per max pax**
- **Snorkeling gear per max pax**
- **1 x Two person kayak**
- **Fishing tackle**
- **12ft rigid bottom inflatable with 25HP outboard**
- **Waterskis, kneeboard, tube & life vests**
- **1 x SUP (stand up paddleboard) and paddle**

## GENERAL SPECIFICATIONS

Length Overall: 15.40m/50ft 6in  
Waterline Length: 14.90m/48ft 11in  
Mast Height: 23.52m/77ft 2in  
Beam: 8.04m/26ft 5in  
Draft: 1.60m/5ft 3in  
Displacement: 20600kg/45415lb  
Fuel Capacity: 920L/243gal  
Water Capacity: 700L/185gal  
Sail Area: 154sqm/1660sqft  
Engines: 2 x 57HP

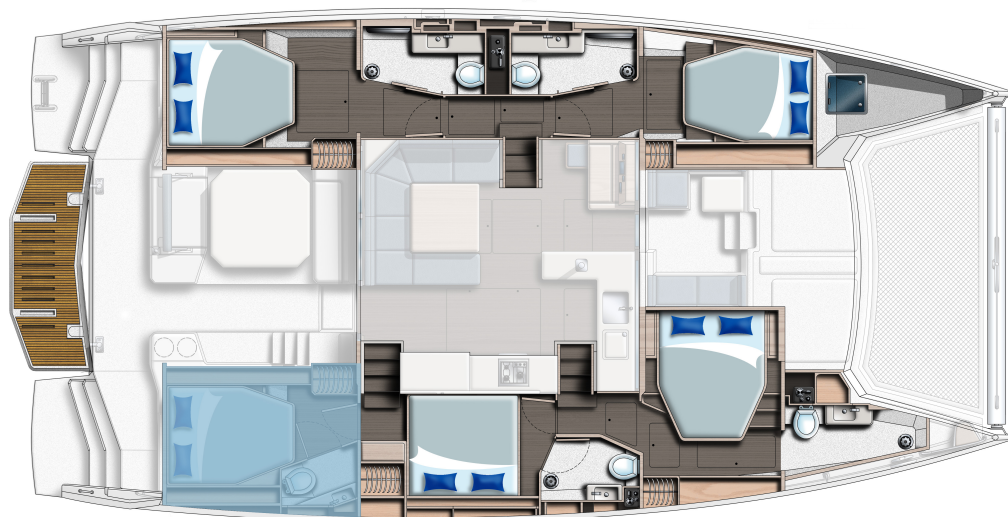

*The Builder reserves the right to change or amend the contents of this document at any time without prior notification to any third party, and no liability will be accepted for errors contained within the same.*